

INDEXED SM/om  
 FOLLOW UP \_\_\_\_\_  
 PROOFED \_\_\_\_\_  
 SCANNED \_\_\_\_\_

Crawford County Recorder  
 Denise Meeves  
**Fee Book 2013-2028**  
 08/22/2013 @11:51AM  
 PLC PLAT CORNER CER  
 Book: Page: # Pages: 1  
 Total Fees: \$0.00

PREPARED BY: PAUL ASSMAN-CRAWFORD COUNTY ENGINEER'S OFFICE-COURTHOUSE-DENISON, IA.-712-263-2449

**UNITED STATES PUBLIC LAND SURVEY CORNER CERTIFICATE  
 OF**

LAND SURVEY MONUMENT SITUATED IN PARADISE TOWNSHIP, THE NORTH 1/4 CORNER OF SECTION 18, T-83N,  
 R-40W OF THE FIFTH P.M. CRAWFORD COUNTY, IOWA.

PREVIOUSLY RECORDED AS NO. 2007-0534

**MONUMENT DESCRIPTION AND REMARKS**

NORTH 1/4 CORNER SEC. 18-83-40

FOUND 5/8" REBAR WITH YELLOW CAP #8893  
 0.5' DEEP. COUNTY GRADED ROAD AND SET 5/8" X 18"  
 REBAR WITH RED CAP #11982, 9" DEEP. CORNER IS  
 ON C. OF O AVE.

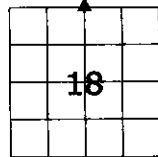

NORTH 1/4 CORNER SEC. 18-83-40

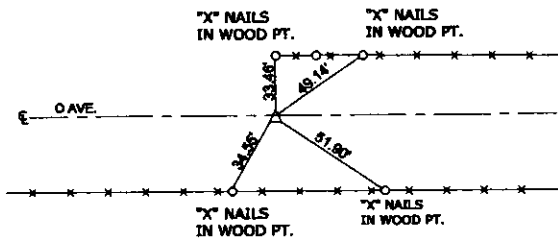

ALL DISTANCES ARE SLOPE CHAINED

**CERTIFICATION:**  
 I HEREBY CERTIFY THAT THIS LAND SURVEYING DOCUMENT WAS PREPARED AND THE RELATED SURVEY  
 WORK WAS PERFORMED BY ME OR UNDER MY DIRECT PERSONAL SUPERVISION AND THAT I AM A DULY  
 LICENSED LAND SURVEYOR UNDER THE LAWS OF THE STATE OF IOWA.

*Paul J. Assman* 7/17/13  
 Signature Date of Survey

PAUL J. ASSMAN 11982 12-31-14  
 Typed Name L.S. No. License Renewal Date

Pages covered by this seal 1

