

INDEXED DM/dm
 FOLLOW UP DM
 PROOFED DM
 SCANNED DM

Instrument #: 2021-1219
 06/04/2021 09:29:34 AM Total Pages: 1
 PLC PLAT COR CERT
 Recording Fee: \$0.00 Transfer Tax: \$0
 Denise Meeves, Recorder, Crawford County Iowa



PREPARED BY: PAUL ASSMAN-CRAWFORD COUNTY ENGINEER'S OFFICE-COURTHOUSE-DENISON, IA.-712-263-2449

UNITED STATES PUBLIC LAND SURVEY CORNER CERTIFICATE OF

LAND SURVEY MONUMENT SITUATED IN PARADISE TOWNSHIP, THE NORTH 1/4 CORNER OF SECTION 32, T-83N,
R-40W OF THE FIFTH P.M. CRAWFORD COUNTY, IOWA.

PREVIOUSLY RECORDED AS NO. 2001-1346

MONUMENT DESCRIPTION AND REMARKS

NORTH 1/4 CORNER SEC. 32-83-40

FOUND YELLOW CAPPED ROD 1.5' DEEP. COUNTY GRADED ROAD AND VERIFIED THAT THE POSITION OF THE YELLOW CAPPED ROD HAD NOT BEEN DISTURBED AND RETIED CORNER.

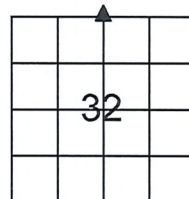

NORTH 1/4 CORNER SEC. 32-83-40

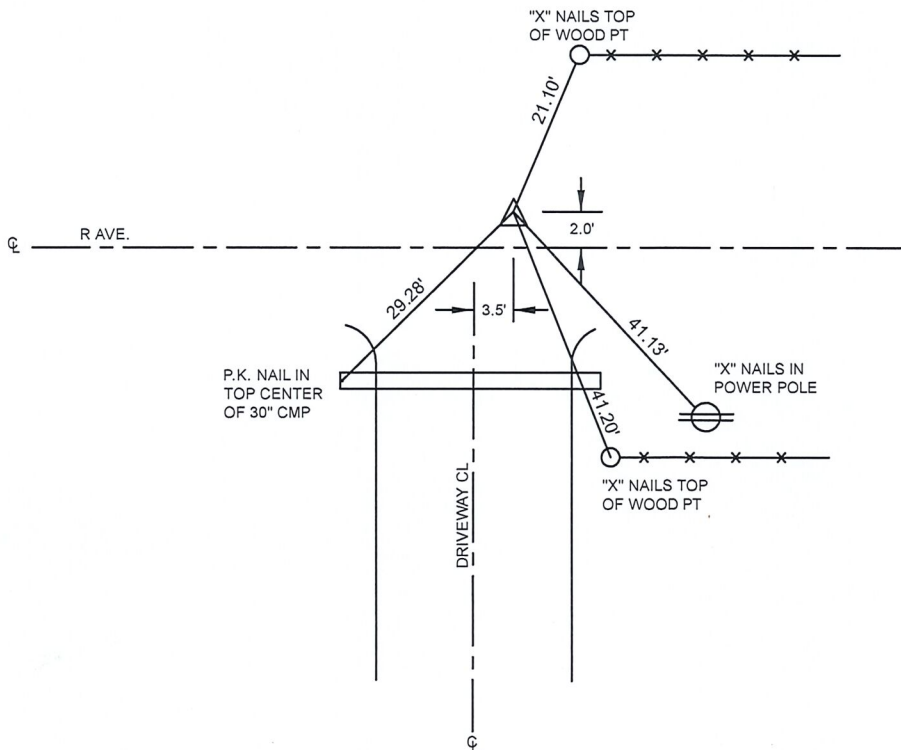

ALL DISTANCES ARE SLOPE CHAINED

CERTIFICATION:

I HEREBY CERTIFY THAT THIS LAND SURVEYING DOCUMENT WAS PREPARED AND THE RELATED SURVEY WORK WAS PERFORMED BY ME OR UNDER MY DIRECT PERSONAL SUPERVISION AND THAT I AM A DULY LICENSED LAND SURVEYOR UNDER THE LAWS OF THE STATE OF IOWA.

Paul J. Assman
Signature

5/27/21
Date of Survey

PAUL J. ASSMAN 11982 12-31-22
 Typed Name L.S. No. License Renewal Date

Pages covered by this seal 1

