

INDEX _____
 SCAN _____
 FOLLOW UP _____
 PROOF _____

Instrument #: 2022-1173
 05/05/2022 01:10:10 PM Total Pages: 1
 PLC PLAT COR CERT
 Recording Fee: \$0.00 Transfer Tax: \$0
 Denise Heeves, Recorder, Crawford County Iowa



PREPARED BY: PAUL ASSMAN-CRAWFORD COUNTY ENGINEER'S OFFICE-COURTHOUSE-DENISON, IA.-712-263-2449

UNITED STATES PUBLIC LAND SURVEY CORNER CERTIFICATE
 OF

LAND SURVEY MONUMENT SITUATED IN MORGAN TOWNSHIP, WEST 1/4 CORNER OF SECTION 18, T-85N, R-40W
 OF THE FIFTH P.M. CRAWFORD COUNTY, IOWA.

PREVIOUSLY RECORDED AS NO. 2008-0037

MONUMENT DESCRIPTION AND REMARKS

WEST 1/4 CORNER SEC. 18-85-40

FOUND BROKEN OFF CONC. MONUMENT 1.3' DEEP,
 COUNTY GRADED ROAD AND SET 5/8" X 18" REBAR WITH
 RED CAP #11982 1.0' DEEP, 4.0' OVER CONC. MONUMENT

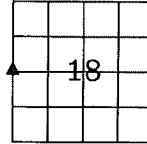

WEST 1/4 CORNER SEC. 18-85-40

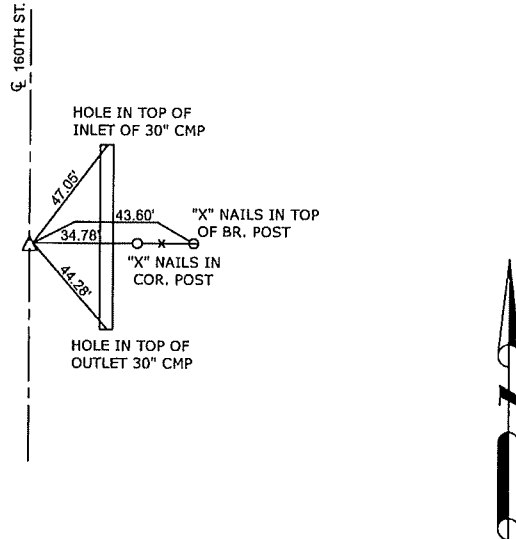

ALL TIE DISTANCES ARE MEASURED HORIZONTALLY USING GPS

CERTIFICATION:

I HEREBY CERTIFY THAT THIS LAND SURVEYING DOCUMENT WAS PREPARED AND THE RELATED SURVEY WORK WAS PERFORMED BY ME OR UNDER MY DIRECT PERSONAL SUPERVISION AND THAT I AM A DULY LICENSED LAND SURVEYOR UNDER THE LAWS OF THE STATE OF IOWA.

Paul J. Assman
 Signature

5/4/22
 Date of Survey

PAUL J. ASSMAN
 Typed Name

11982
 L.S. No.

12-31-22
 License Renewal Date

Pages covered by this seal 1

