

INDEX _____
SCAN _____
FOLLOW UP _____
PROOF _____

Instrument #: 2022-1176
05/05/2022 01:10:10 PM Total Pages: 1
PLC PLAT COR CERT
Recording Fee: \$0.00 Transfer Tax: \$0
Denise Meeves, Recorder, Crawford County Iowa

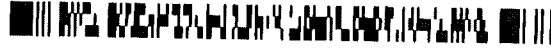

PREPARED BY: PAUL ASSMAN-CRAWFORD COUNTY ENGINEER'S OFFICE-COURTHOUSE-DENISON, IA.-712-263-2449

UNITED STATES PUBLIC LAND SURVEY CORNER CERTIFICATE OF

LAND SURVEY MONUMENT SITUATED IN MORGAN TOWNSHIP, SOUTHWEST CORNER OF SECTION 7, T-85N,
R-40W OF THE FIFTH P.M. CRAWFORD COUNTY, IOWA.

PREVIOUSLY RECORDED AS NO. 2019-0095

MONUMENT DESCRIPTION AND REMARKS

SOUTHWEST CORNER SEC. 7-85-40

FOUND REBAR 0.3' DEEP. COUNTY GRADED ROAD AND
SET 5/8" X 18" REBAR WITH RED CAP #11982 1.0' DEEP
AND RETIED

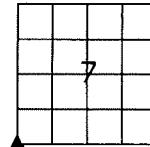

SOUTHWEST CORNER SEC. 7-85-40

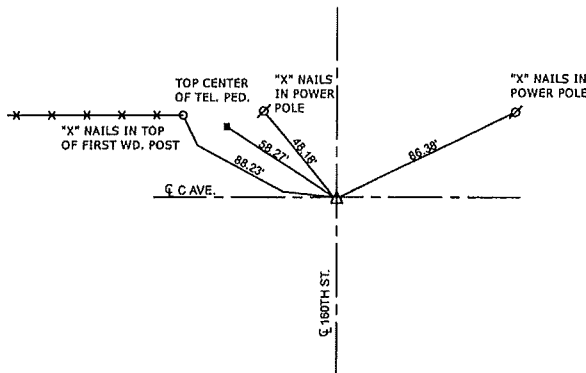

ALL TIE DISTANCES ARE MEASURED HORIZONTALLY USING GPS

CERTIFICATION:

I HEREBY CERTIFY THAT THIS LAND SURVEYING DOCUMENT WAS PREPARED AND THE RELATED SURVEY WORK WAS PERFORMED BY ME OR UNDER MY DIRECT PERSONAL SUPERVISION AND THAT I AM A DULY LICENSED LAND SURVEYOR UNDER THE LAWS OF THE STATE OF IOWA.

Signature

5/4/22
Date of Survey

PAUL J. ASSMAN
Typed Name

11982
L.S. No.

12-31-22
License Renewal Date

Pages covered by this seal 1

