

INDEX SM  
 SCAN \_\_\_\_\_  
 FOLLOW UP \_\_\_\_\_  
 PROOF \_\_\_\_\_

Instrument #: 2022-1530  
 06/10/2022 02:57:32 PM Total Pages: 1  
 PLC PLAT COR CERT  
 Recording Fee: \$0.00 Transfer Tax: \$0  
 Denise Meeves, Recorder, Crawford County Iowa



PREPARED BY: PAUL ASSMAN-CRAWFORD COUNTY ENGINEER'S OFFICE-COURTHOUSE-DENISON, IA.-712-263-2449

UNITED STATES PUBLIC LAND SURVEY CORNER CERTIFICATE  
 OF

LAND SURVEY MONUMENT SITUATED IN SOLDIER TOWNSHIP, NORTH 1/4 CORNER OF SECTION 14, T-85N,  
 R-41W OF THE FIFTH P.M. CRAWFORD COUNTY, IOWA.

PREVIOUSLY RECORDED AS NO. 2012-0102

MONUMENT DESCRIPTION AND REMARKS

NORTH 1/4 CORNER SEC. 14-85-41

NO CORNER FOUND AT THIS LOCATION.  
 USED 3 EXISTING TIES TO ESTABLISH LOCATION. COUNTY  
 GRADED ROAD AND SET 5/8" X 18" REBAR WITH RED CAP  
 #11982 1.0' DEEP AND RETIED

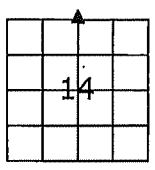

NORTH 1/4 CORNER SEC. 14-85-41

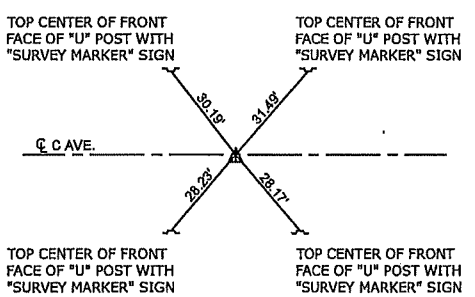

ALL TIE DISTANCES ARE MEASURED HORIZONTALLY USING GPS

CERTIFICATION:  
 I HEREBY CERTIFY THAT THIS LAND SURVEYING DOCUMENT WAS PREPARED AND THE RELATED SURVEY  
 WORK WAS PERFORMED BY ME OR UNDER MY DIRECT PERSONAL SUPERVISION AND THAT I AM A DULY  
 LICENSED LAND SURVEYOR UNDER THE LAWS OF THE STATE OF IOWA.

Paul J. Assman  
 Signature

5/26/22  
 Date of Survey

PAUL J. ASSMAN      11982      12-31-22  
 Typed Name      L.S. No.      License Renewal Date

Pages covered by this seal 1

