

FILED HP
FILED HP
FILED _____
FILED _____

01/12/2012 01:02AM
PLC: PLAT CORNER CER
Book: Page: # Pages: 1
Total Fees: \$7.00

Prepared by: Nathan H. Carlson Address: 3701 12th Street N, Suite 206 Phone: 320-253-9495
St. Cloud, MN 56303

UNITED STATES PUBLIC LAND SURVEY CORNER CERTIFICATE FOR

Land survey monuments situated in Section 15, Township 85 N

Range 41 W of the Fifth Principal Meridian, Crawford County, Iowa.

Previously recorded in Doc. No 93-0402 in County Recorder's Office.

(Show reason for preparing this certificate, the evidence and detailed procedures used in establishing the corner positions & monumentation found or placed.)

MONUMENT DESCRIPTION AND REMARKS:

Found 3/8" rebar & 2 ties from shellberg tie sheet dated Feb. 17, 1993. Two new ties were established.

PLAN - VIEW

(Show a minimum of three reference ties to durable physical objects, relevant monuments and physical conditions that will enable recovery of the corner.)

All Distances horizontal

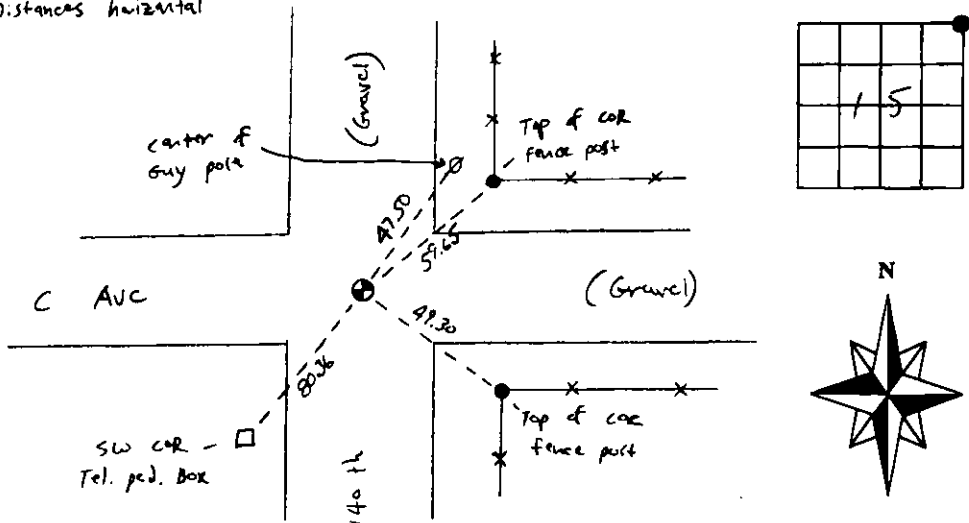

SEAL

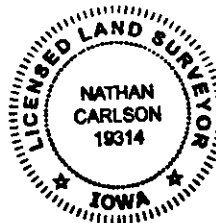

SLSI-3/98

I hereby certify that this land surveying document was prepared and the related survey work was performed by me or under my direct personal supervision and that I am a duly licensed Land Surveyor under the laws of the State of Iowa.

Nathan H. Carlson 1/4/2012
Signature Date

Typed/Printed Name: Nathan H. Carlson

License Number: 19314

My license renewal date is December 31, 2018

Pages or sheets covered by this seal: This sheet

Corners to be Indexed

Corners	Section	Twp.	Range
NE	15	85 N	41 W