

INDEXED Km  
 FOLLOW UP \_\_\_\_\_  
 PROOFED \_\_\_\_\_  
 SCANNED \_\_\_\_\_

Instrument #: 2018-1956  
 09/19/2018 08:27:33 AM Total Pages: 1  
 PLC PLAT CORNER CER  
 Recording Fee: \$0.00 Transfer Tax: \$0  
 Denise Meeves, Recorder, Crawford County Iowa



PREPARED BY: PAUL ASSMAN-CRAWFORD COUNTY ENGINEER'S OFFICE-COURTHOUSE-DENISON, IA.-712-263-2449

## UNITED STATES PUBLIC LAND SURVEY CORNER CERTIFICATE OF

LAND SURVEY MONUMENT SITUATED IN SOLDIER TOWNSHIP, THE SOUTHWEST CORNER OF SECTION 16,  
T-85N, R-41W OF THE FIFTH P.M. CRAWFORD COUNTY, IOWA.

PREVIOUSLY RECORDED AS NO. 2006-2939

### MONUMENT DESCRIPTION AND REMARKS

SOUTHWEST CORNER SEC. 16-85-41

FOUND LEAD PLUG AS SET ACCORDING TO PREVIOUS TIES. COMPLETED DIAMOND GRINDING OF ROADWAY SURFACE. SET PK NAIL FLUSH WITH SURFACE AND RETIED CORNER.

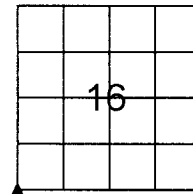

SOUTHWEST CORNER SEC. 16-85-41

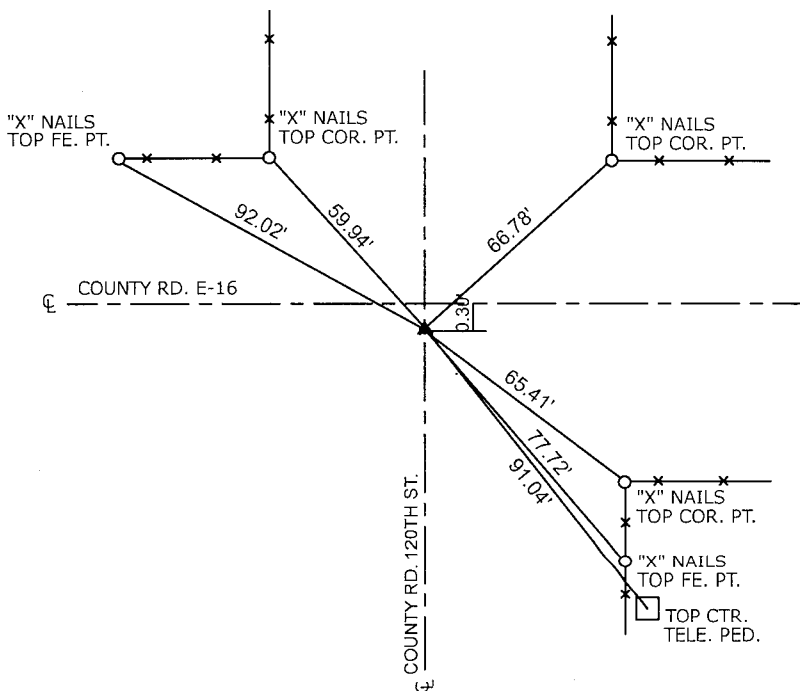

ALL DISTANCES ARE PLUMB CHAINED

State Plane Coordinates  
 Projection - Iowa North  
 Position - NAD 83  
 Ellipsoid - GRS 1980  
 GEOID Model - IAGeoid 12A  
 Latitude: 42.16786934  
 Longitude: 95.63319196

**CERTIFICATION:**

I HEREBY CERTIFY THAT THIS LAND SURVEYING DOCUMENT WAS PREPARED AND THE RELATED SURVEY WORK WAS PERFORMED BY ME OR UNDER MY DIRECT PERSONAL SUPERVISION AND THAT I AM A DULY LICENSED LAND SURVEYOR UNDER THE LAWS OF THE STATE OF IOWA.

|                |                      |
|----------------|----------------------|
|                | 7/31/18              |
| Signature      | Date of Survey       |
| PAUL J. ASSMAN | 11982                |
| Typed Name     | L.S. No.             |
|                | 12-31-18             |
|                | License Renewal Date |

