

INDEXED KM  
 FOLLOW UP \_\_\_\_\_  
 PROOFED \_\_\_\_\_  
 SCANNED \_\_\_\_\_

Instrument #: 2018-1958  
 09/19/2018 08:27:33 AM Total Pages: 1  
 PLC PLAT CORNER CER  
 Recording Fee: \$0.00 Transfer Tax: \$0  
 Denise Meeves, Recorder, Crawford County Iowa



PREPARED BY: PAUL ASSMAN-CRAWFORD COUNTY ENGINEER'S OFFICE-COURTHOUSE-DENISON, IA.-712-263-2449

## UNITED STATES PUBLIC LAND SURVEY CORNER CERTIFICATE OF

LAND SURVEY MONUMENT SITUATED IN SOLDIER TOWNSHIP, THE SOUTHWEST CORNER OF SECTION 15,  
T-85N, R-41W OF THE FIFTH P.M. CRAWFORD COUNTY, IOWA.

PREVIOUSLY RECORDED AS NO. 93-0403

### MONUMENT DESCRIPTION AND REMARKS

SOUTHWEST CORNER SEC. 15-85-41

FOUND PK NAIL AS SET ACCORDING TO PREVIOUS TIES.  
 COMPLETED DIAMOND GRINDING OF ROADWAY SURFACE  
 AND RESET PK NAIL 0.04' DEEP. RETIED CORNER.

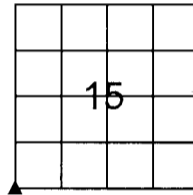

SOUTHWEST CORNER SEC. 15-85-41

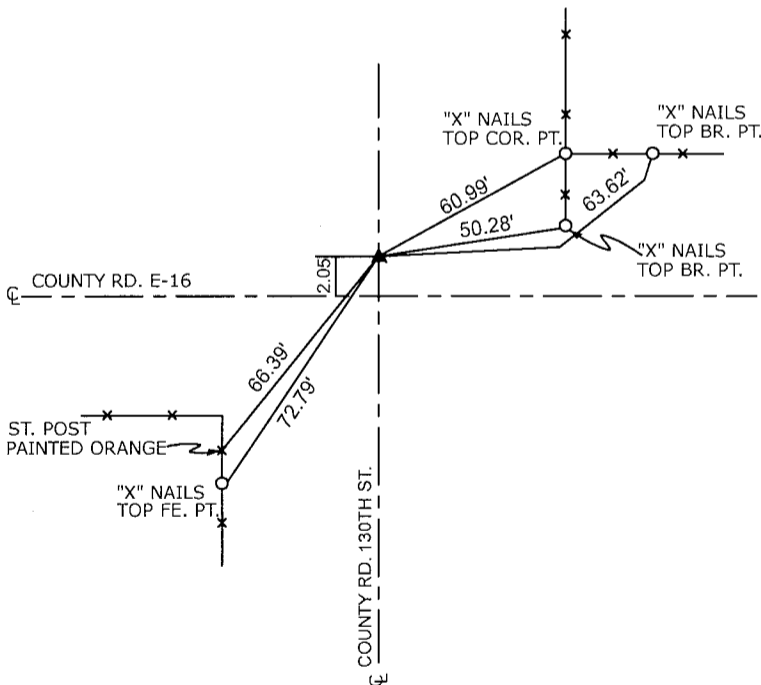

ALL DISTANCES ARE PLUMB CHAINED

State Plane Coordinates  
 Projection - Iowa North  
 Position - NAD 83  
 Ellipsoid - GRS 1980  
 GEOID Model - IAGeoid 12A  
 Latitude: 42.16795932  
 Longitude: 95.61382108

**CERTIFICATION:**

I HEREBY CERTIFY THAT THIS LAND SURVEYING DOCUMENT WAS PREPARED AND THE RELATED SURVEY WORK WAS PERFORMED BY ME OR UNDER MY DIRECT PERSONAL SUPERVISION AND THAT I AM A DULY LICENSED LAND SURVEYOR UNDER THE LAWS OF THE STATE OF IOWA.

<p><i>Paul J. Assman</i>          _____          Signature</p>	<p><i>7/13/18</i>          _____          Date of Survey</p>
<p>PAUL J. ASSMAN          _____          Typed Name</p>	<p>11982          _____          L.S. No.</p>
<p>12-31-18          _____          License Renewal Date</p>	

