

INDEXED KM
 FOLLOW UP _____
 PROOFED _____
 SCANNED _____

Instrument #: 2018-1959
 09/19/2018 08:27:33 AM Total Pages: 1
 PLC PLAT CORNER CER
 Recording Fee: \$0.00 Transfer Tax: \$0
 Denise Meeves, Recorder, Crawford County Iowa



PREPARED BY: PAUL ASSMAN-CRAWFORD COUNTY ENGINEER'S OFFICE-COURTHOUSE-DENISON, IA.-712-263-2449

UNITED STATES PUBLIC LAND SURVEY CORNER CERTIFICATE OF

LAND SURVEY MONUMENT SITUATED IN SOLDIER TOWNSHIP, THE SOUTH 1/4 CORNER OF SECTION 15, T-85N,
R-41W OF THE FIFTH P.M. CRAWFORD COUNTY, IOWA.

PREVIOUSLY RECORDED AS NO. 93-0403

MONUMENT DESCRIPTION AND REMARKS

SOUTH 1/4 CORNER SEC. 15-85-41

FOUND 3/8" X 3 1/2" BOLT AS SET ACCORDING TO PREVIOUS TIES. COMPLETED DIAMOND GRINDING OF ROADWAY SURFACE. RESET CARRIAGE BOLT 0.05' DEEP AND INLINE WITH FENCE LINE RUNNING NORTH. RETIED CORNER.

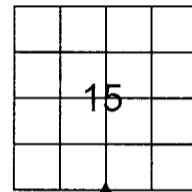

SOUTH 1/4 CORNER SEC. 15-85-41

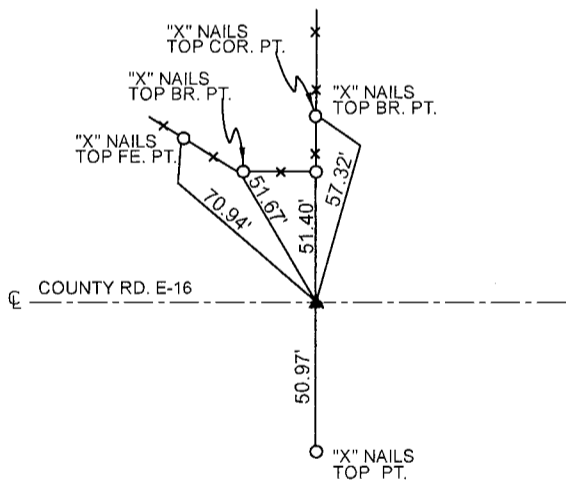

ALL DISTANCES ARE PLUMB CHAINED

State Plane Coordinates
 Projection - Iowa North
 Position - NAD 83
 Ellipsoid - GRS 1980
 GEOID Model - IAGEoid 12A
 Latitude: 42.16791320
 Longitude: 95.60405046

CERTIFICATION:

I HEREBY CERTIFY THAT THIS LAND SURVEYING DOCUMENT WAS PREPARED AND THE RELATED SURVEY WORK WAS PERFORMED BY ME OR UNDER MY DIRECT PERSONAL SUPERVISION AND THAT I AM A DULY LICENSED LAND SURVEYOR UNDER THE LAWS OF THE STATE OF IOWA.

	7/31/19	
Signature	Date of Survey	
PAUL J. ASSMAN	11982	12-31-18
Typed Name	L.S. No.	License Renewal Date

