

Crawford County Recorder
Denise Meeves
Fee Book 2012-0080

01/12/2012 01:09AM
PLC PLAT CORNER CER
Book: Page: # Pages: 1
Total Fees: \$7.00

20 20

Prepared by: Nathan H. Carlson Address: 3701 12th Street N, Suite 206, Phone: 320-253-9495
St. Cloud, MN 56303

UNITED STATES PUBLIC LAND SURVEY CORNER CERTIFICATE FOR

Land survey monuments situated in Section 25, Township 85 N

Range 41 W, of the Fifth Principal Meridian, Crawford County, Iowa.

Previously recorded in Doc. No. 93-0986 in County Recorder's Office.

(Show reason for preparing this certificate, the evidence and detailed procedures used in establishing the corner positions & monumentation found or placed.)

MONUMENT DESCRIPTION AND REMARKS: Found 1/2" rebar 5 ft north of the
road centerline. 1 tie was found from the Hillhouse certificate,
dated 3/30/93 and the measurement fit well. Additional ties
were established.

PLAN - VIEW

(Show a minimum of three reference ties to durable physical objects, relevant monuments and physical conditions that will enable recovery of the corner.)

All distances are horizontal

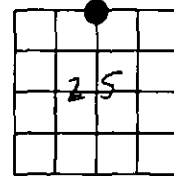
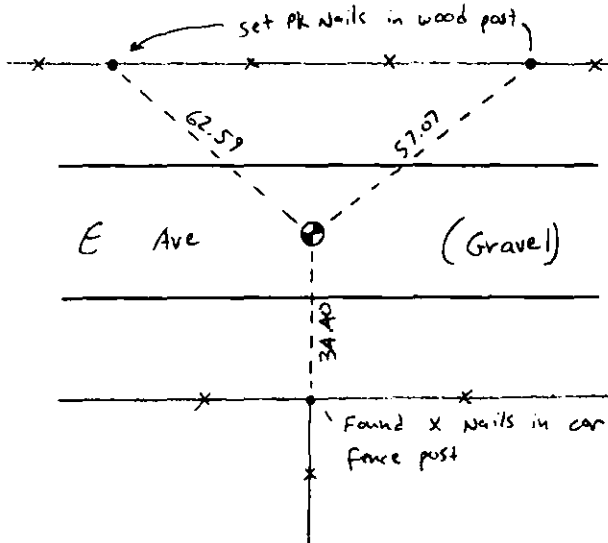

SEAL

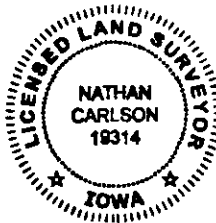

SLSI-3/98

I hereby certify that this land surveying document was prepared and the related survey work was performed by me or under my direct personal supervision and that I am a duly licensed Land Surveyor under the laws of the State of Iowa.

Nathan H. Carlson 1/4/2012
Signature Date

Typed/Printed Name: Nathan H. Carlson

License Number: 19314

My license renewal date is December 31, 2012.

Pages or sheets covered by this seal: This sheet

Corners to be Indexed

Corners	Section	Twp.	Range
<u>N 1/4</u>	<u>25</u>	<u>85 N</u>	<u>41 W</u>