

JP

Prepared by: Nathan H. Carlson Address: 3701 12th Street N, Suite 206, Phone: 320-253-9495
St. Cloud, MN 56303

UNITED STATES PUBLIC LAND SURVEY CORNER CERTIFICATE FOR

Land survey monuments situated in Section 26, Township 85N

Range 41W, of the Fifth Principal Meridian, Crawford County, Iowa.

Previously recorded in _____ in County Recorder's Office.

(Show reason for preparing this certificate, the evidence and detailed procedures used in establishing the corner positions & monumentation found or placed.)

MONUMENT DESCRIPTION AND REMARKS: 1939 Highway Department notes indicate a concrete monument was placed over the remains of a black walnut stake. We excavated a 5'x8' by 3' deep hole near the corner and found a 4" x 4" x 24" concrete monument. Set a 1/2" rebar with LS cap 19314 above the concrete monument and established new reference ties as noted below.

PLAN - VIEW

(Show a minimum of three reference ties to durable physical objects, relevant monuments and physical conditions that will enable recovery of the corner.)

* ALL TIES ARE A NAIL & WASHER IN FENCE POST

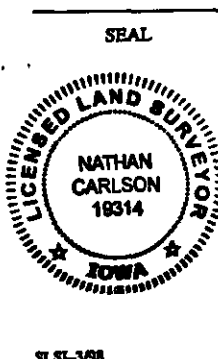
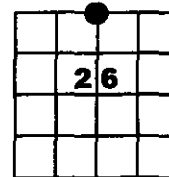
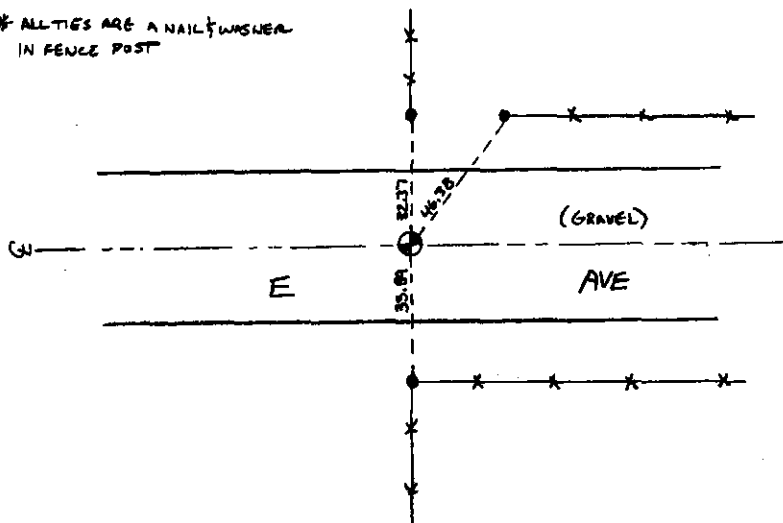

SLSI-3/98

I hereby certify that this land surveying document was prepared and the related survey work was performed by me or under my direct personal supervision and that I am a duly licensed Land Surveyor under the laws of the State of Iowa.

Nathan H. Carlson 1/9/2012
 Signature Date

Typed/Printed Name: Nathan H. Carlson

License Number: 19314

My license renewal date is December 31, 2012

Pages or sheets covered by this seal: This sheet

Corners to be Indexed

Corners	Section	Twp.	Range
N1/4	26	85N	41W