

21
20
N 1/4 cor. sec. 28 - T85N-R41W

Along 4' x 5' hole 8' deep and found a
7" x 9" rock at a depth of 2', a
6" x 8" x 12" rock at a depth of 2 1/2', a
7" x 7" x 12" rock at a depth of 4', a
7" x 2" x 11" rock at a depth of 5'. Also
found a few brick chips.

Lowered evidence and set C.M.

Cor. substantiated by notes in Co. report

BK. "11" p. 71.

20. This room is sparsely furnished.

20.5 S

21.1 N

28.9 NNW (Gate post)

N 1/4

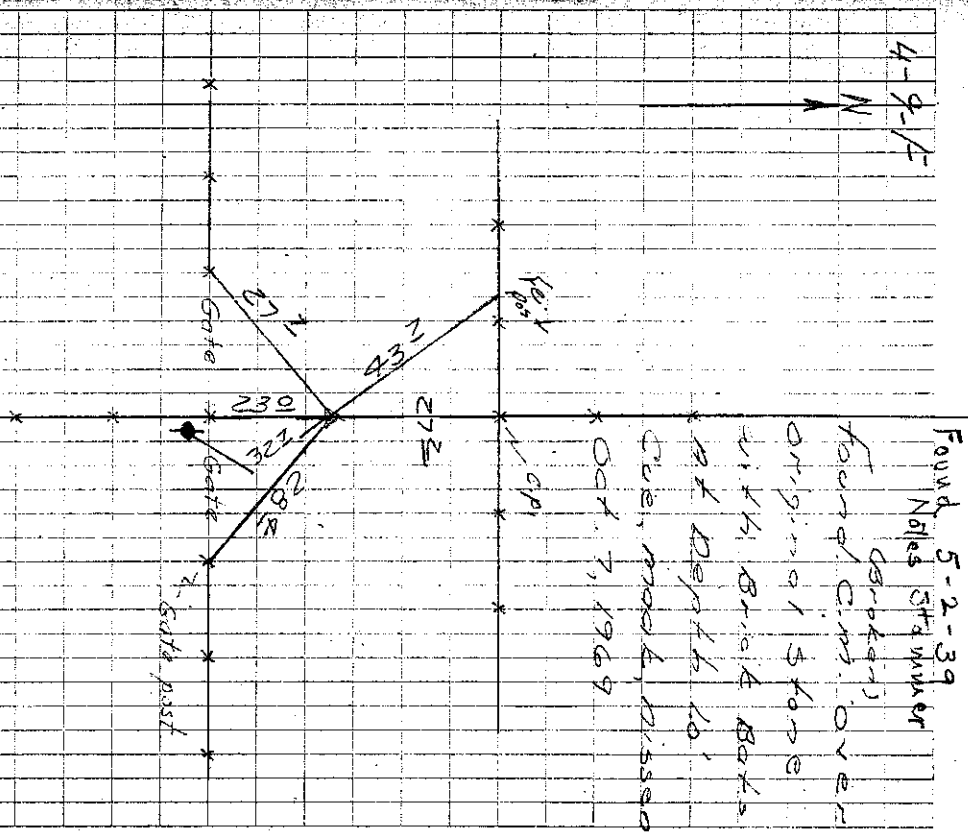

Found 5-2-39
Notes (Sta number)
found of C.M. over
original stone
with brick bats
at depth 10'
Cube, rock, disaso
Oct. 7, 1969