

INDEX VM
SCAN _____
FOLLOW UP _____
PROOF _____

Instrument #: 2025-0398
02/25/2025 08:25:39 AM Total Pages: 1
PLC PLAT COR CERT
Recording Fee: \$0.00 Transfer Tax: \$0
Sara Mesack, Recorder, Crawford County Iowa



PREPARED BY: PAUL ASSMAN-CRAWFORD COUNTY ENGINEER'S OFFICE-COURTHOUSE-DENISON, IA-712-263-2449

UNITED STATES PUBLIC LAND SURVEY CORNER CERTIFICATE OF

LAND SURVEY MONUMENT SITUATED IN SOLDIER TOWNSHIP, NORTH 1/4 CORNER OF SECTION 28, T-85N,
R-41W OF THE FIFTH P.M. CRAWFORD COUNTY, IOWA.

PREVIOUSLY RECORDED IN SOLDIER TWP. FIELD BOOK PG. 84, COUNTY ENGINEERS OFFICE

MONUMENT DESCRIPTION AND REMARKS

NORTH 1/4 CORNER SEC. 28-85-41

CORNER WAS NOT FOUND. COUNTY GRADED ROAD AND SET 5/8" X 18" REBAR WITH RED CAP#11982 1.0' DEEP USING EXISTING TIE EVIDENCE. CORNER LOCATION FALLS IN LINE WITH THE NORTH/SOUTH FENCES. CORNER WAS RETIED.

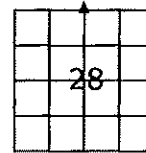

NORTH 1/4 CORNER SEC. 28-85-41

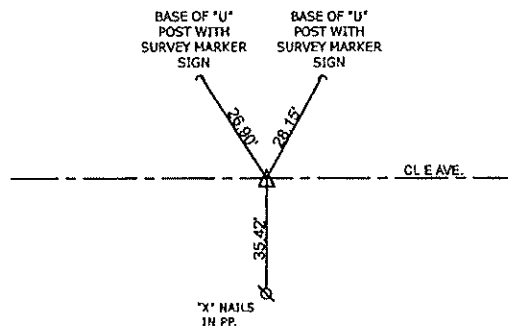

ALL TIE DISTANCES ARE MEASURED HORIZONTALLY USING GPS

CERTIFICATION:

I HEREBY CERTIFY THAT THIS LAND SURVEYING DOCUMENT WAS PREPARED AND THE RELATED SURVEY WORK WAS PERFORMED BY ME OR UNDER MY DIRECT PERSONAL SUPERVISION AND THAT I AM A DULY LICENSED LAND SURVEYOR UNDER THE LAWS OF THE STATE OF IOWA.

Signature

Date of Survey

PAUL J. ASSMAN
Typed Name

11982
L.S. No.

12-31-26
License Renewal Date

Pages covered by this seal 1

