

Ida Co. NE cor. sec. 2 - T85N. R1. E.  
2.1

Sought by ties (Proj #c-34, p. 21)  
Found lath, 2"x2" stake 2' long, two  
small stones, and a 5" diameter rock  
18" long standing on end.  
Lowered and set C.M.

Ties from X spk. in cor. fe. posts  
45.3 NE of cor. fe. post  
41.9 SE of cor. fe. post  
33.3 W of cor. fe. post

Happy Birthday  
To me

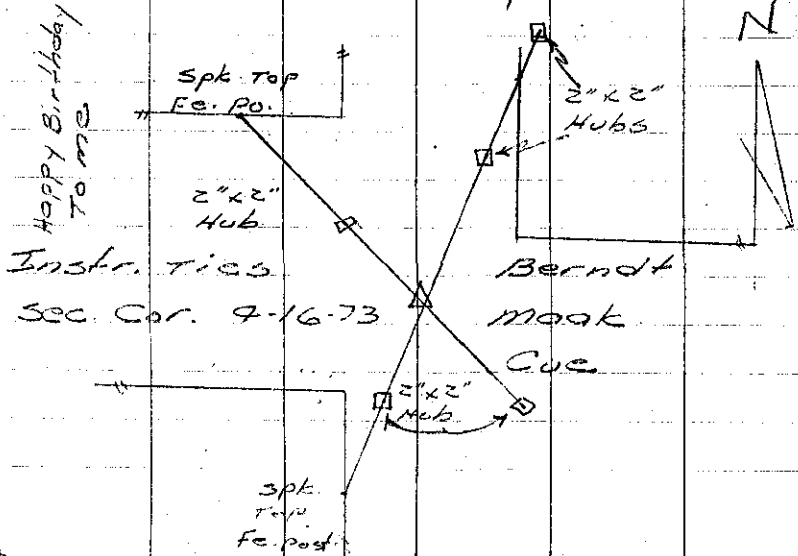

Found Mar. 13<sup>th</sup>, 1939

DEC, 1960

OK 6/19/64  
Richard's  
Found Iron pins  
6' deep. 11/10-72  
New Ties  
Ellieman, bearing  
Remark

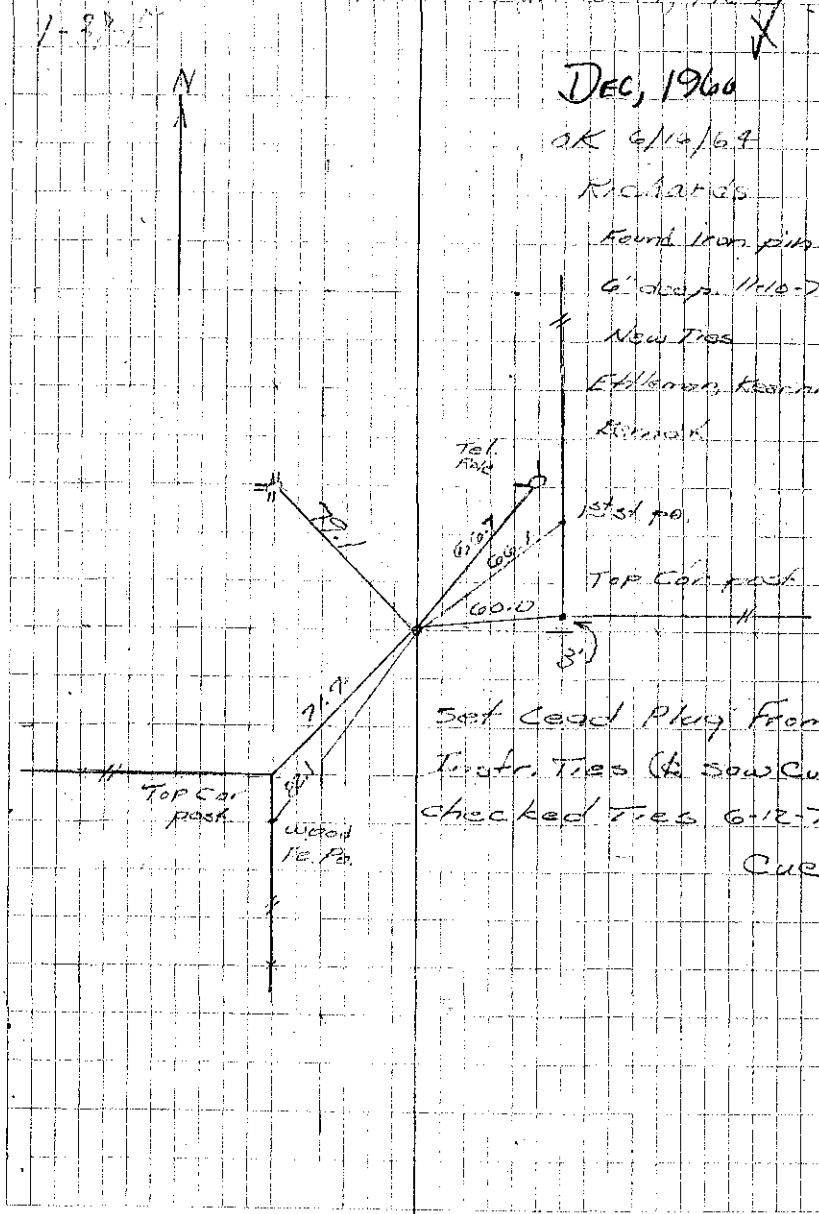

Set Lead Plug from  
Instr. Ties (to saw cut)  
checked Ties 6-12-73  
Cue