

33-34 E 1/4 cor. sec. 33-T85N-R41W

Dug 2' x 16' hole 3 1/2' deep.

Found nothing.

Dug 2' x 2' hole 4' deep and found pieces  
of brick, coal, steel file. Lowered  
evidence and set C.M.

Cor. substantiated by plat from Twp. Clerk.

Ties from X spks

48.0 SW from cor. fe. post

35.7 E " " " "

36.0 WSW " " " "

38.5 WSW from boulder cluster

Cor. is 6' deep

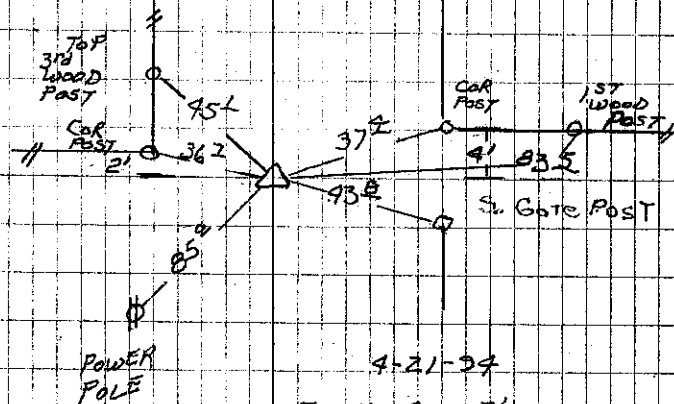
3-64-3  
4-32-FN  
↑

Apr 22, May 11, 1939

Dec 3, 1958

Lochmiller

4-21-39

FOUND CTD 7' DEEP

SGT 3/4" REBAR 8' DEEP

BERNDT, CURNYU