

Crawford County Recorder
 Denise Meeves
Fee Book 2012-1212
 05/31/2012 802:00PM
 PLC PLAT CORNER CER
 Book: Page: # Pages: 1
 Total Fees: \$0.00

RECEIVED _____
 PAID TO _____
 DATE _____
 \$ _____

PREPARED BY: PAUL ASSMAN-CRAWFORD COUNTY ENGINEER'S OFFICE-COURTHOUSE-DENISON, IA.-712-263-2449

**UNITED STATES PUBLIC LAND SURVEY CORNER CERTIFICATE
 OF**

LAND SURVEY MONUMENT SITUATED IN SOLDIER TOWNSHIP, THE EAST 1/4 CORNER OF SECTION 3, T-85N,
 R-41W OF THE FIFTH P.M. CRAWFORD COUNTY, IOWA.

PREVIOUSLY RECORDED AS NO.

MONUMENT DESCRIPTION AND REMARKS

EAST 1/4 CORNER SEC. 3-85-41

FOUND 1/2" REBAR WITH RED CAP "COOPER" 1.1' DEEP
 RETIED CORNER.

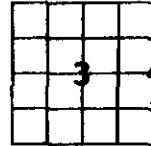

EAST 1/4 CORNER SEC. 3-85-41

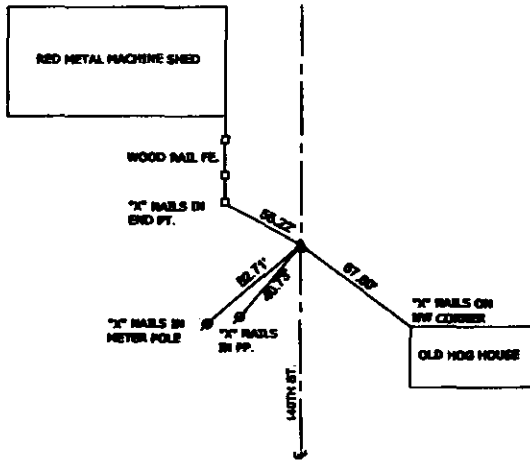

ALL DISTANCES ARE SLOPE CHAINED

CERTIFICATION: I HEREBY CERTIFY THAT THIS LAND SURVEYING DOCUMENT WAS PREPARED AND THE RELATED SURVEY WORK WAS PERFORMED BY ME OR UNDER MY DIRECT PERSONAL SUPERVISION AND THAT I AM A DULY LICENSED LAND SURVEYOR UNDER THE LAWS OF THE STATE OF IOWA.		
<i>Paul J. Assman</i> Signature	11/10/2011 Date of Survey	
PAUL J. ASSMAN Typed Name	11982 L.S. No.	
		12-31-12 License Renewal Date
Pages covered by this seal 1		