

FILED 2003 OCT 10 PH 3:18
 2003-3956
 DENISE MEEVES, RECORDER
 Denise Meeves
 FEE \$11.00
 Mary Eiten, Deputy

PREPARED BY: MICKAEL BERNDT
 CRAWFORD COUNTY ENGINEERS OFFICE - COURTHOUSE - DENISON, IA. - 712-263-2449

**UNITED STATES PUBLIC LAND SURVEY CORNER CERTIFICATE
 OF**

LAND SURVEY MONUMENT SITUATED IN SOLDIER TOWNSHIP, THE NORTH 1/4
 CORNER OF SECTION 8, T-85N, R-41W OF THE 5TH P.M. CRAWFORD COUNTY, IOWA.

MONUMENT DESCRIPTION AND REMARKS

NORTH 1/4 CORNER SEC. 8-85-41
 FOUND 1" REBAR 8" DEEP BEFORE GRADING.
 CRAWFORD COUNTY GRADED THE ROAD DURING THE SUMMER OF 2003.
 FOUND THE 1" REBAR AT A DEPTH OF 41".
 SET 1" DIA. X 27" REBAR WITH YELLOW CAP #14808 OVER IT AT DEPTH OF 14".

PLAN VIEW SHOWING RELATIVE LOCATION OF MONUMENT AND REFERENCE POINTS.

NORTH 1/4 CORNER SEC. 8-85-41
 SET 1" DIA. X 27" REBAR WITH
 YELLOW CAP #14808 14" DEEP

DISTANCES ARE SLOPED CHAINED

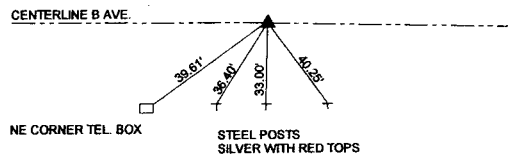

CORNER: NORTH 1/4
 SECTION: 8
 TOWNSHIP: 85N
 RANGE: 41W

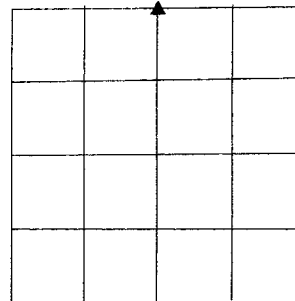

I HEREBY CERTIFY THAT THIS LAND SURVEYING DOCUMENT WAS PREPARED
 AND THE RELATED SURVEY WORK WAS PERFORMED BY ME OR UNDER MY
 DIRECT PERSONAL SUPERVISION AND THAT I AM A DULY LICENSED LAND
 SURVEYOR UNDER THE LAWS OF THE STATE OF IOWA.

Mickael F. Berndt
 MICKAEL F. BERNDT
 IA. LICENSE NO. 14808

10-10-03
 DATE
 EXP. DATE 12-31-04

