

INDEXED KM
 FOLLOW UP _____
 PROOFED _____
 SCANNED _____

Instrument #: 2018-1945
 09/19/2018 08:27:33 AM Total Pages: 1
 PLC PLAT CORNER CER
 Recording Fee: \$0.00 Transfer Tax: \$0
 Denise Meeves, Recorder, Crawford County Iowa



PREPARED BY: PAUL ASSMAN-CRAWFORD COUNTY ENGINEER'S OFFICE-COURTHOUSE-DENISON, IA.-712-263-2449

UNITED STATES PUBLIC LAND SURVEY CORNER CERTIFICATE OF

LAND SURVEY MONUMENT SITUATED IN STOCKHOLM TOWNSHIP, THE NORTHEAST CORNER OF SECTION 10,
T-85N, R-38W OF THE FIFTH P.M. CRAWFORD COUNTY, IOWA.

PREVIOUSLY RECORDED AS NO. 2003-4351

MONUMENT DESCRIPTION AND REMARKS

NORTHEAST CORNER SEC. 10-85-38

FOUND 5/8" REBAR WITH YELLOW CAP #8893 0.8' DEEP IN ACCORDANCE WITH PREVIOUS TIES. COUNTY USED THE CORNER AS CONTROL FOR A BRIDGE REPLACEMENT PROJECT AND RETIED CORNER.

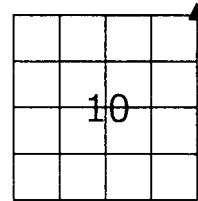

NORTHEAST CORNER SEC. 10-85-38

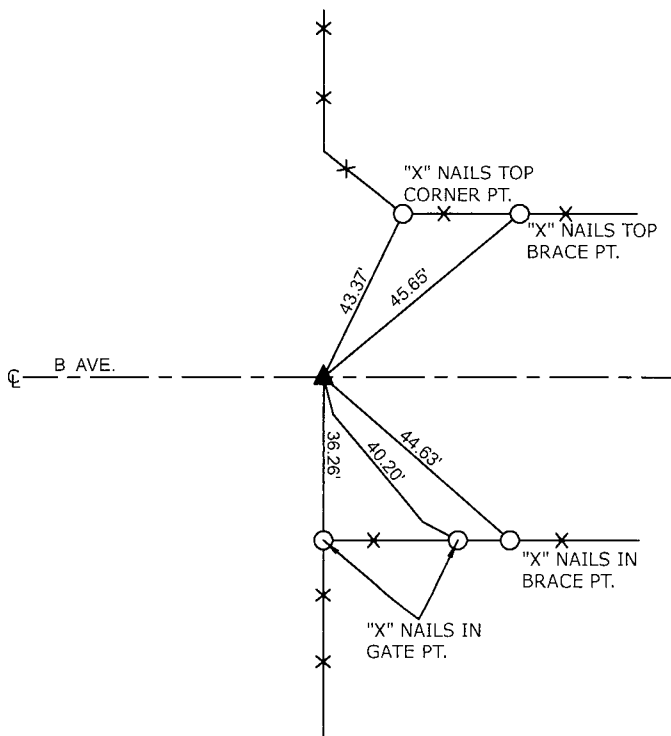

ALL DISTANCES ARE SLOPE CHAINED

CERTIFICATION:

I HEREBY CERTIFY THAT THIS LAND SURVEYING DOCUMENT WAS PREPARED AND THE RELATED SURVEY WORK WAS PERFORMED BY ME OR UNDER MY DIRECT PERSONAL SUPERVISION AND THAT I AM A DULY LICENSED LAND SURVEYOR UNDER THE LAWS OF THE STATE OF IOWA.

	7/31/18
Signature	Date of Survey
PAUL J. ASSMAN	11982
Typed Name	L.S. No.
	12-31-18
	License Renewal Date

