

INDEXED
FOLLOW UP
PROOFED
SCANNED

REC010235



Crawford County Recorder Denise Meeves
FEE BOOK 2006-1161 4/28/2006 @ 12:37PM
PLC PLAT CORNER CERBook: Page: #: 1
Total Fees: \$7.00

PREPARED BY - TERENCE E. CRAWFORD - SUNDQUIST ENGINEERING - 120 S. MAIN, DENISON, IOWA 51442 - PHONE (712) 263-8118

UNITED STATES PUBLIC LAND SURVEY CORNER CERTIFICATE OF

LAND SURVEY MONUMENT SITUATED IN SECTION 2, T 82 N, R 40 W OF
THE 5TH P.M., CRAWFORD COUNTY, IOWA.
PREVIOUSLY RECORDED IN BOOK _____, PAGE _____, OTHER _____

MONUMENT DESCRIPTION AND REMARKS

NE CORNER - FOUND IRON PIN W/CAP #5798, 1.0' DEEP BY WITNESS
POST.

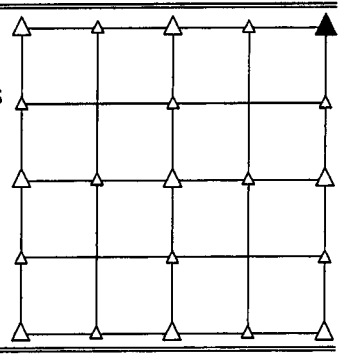

PLAN VIEW SHOWING RELATIVE LOCATION OF MONUMENT AND REFERENCE POINTS.

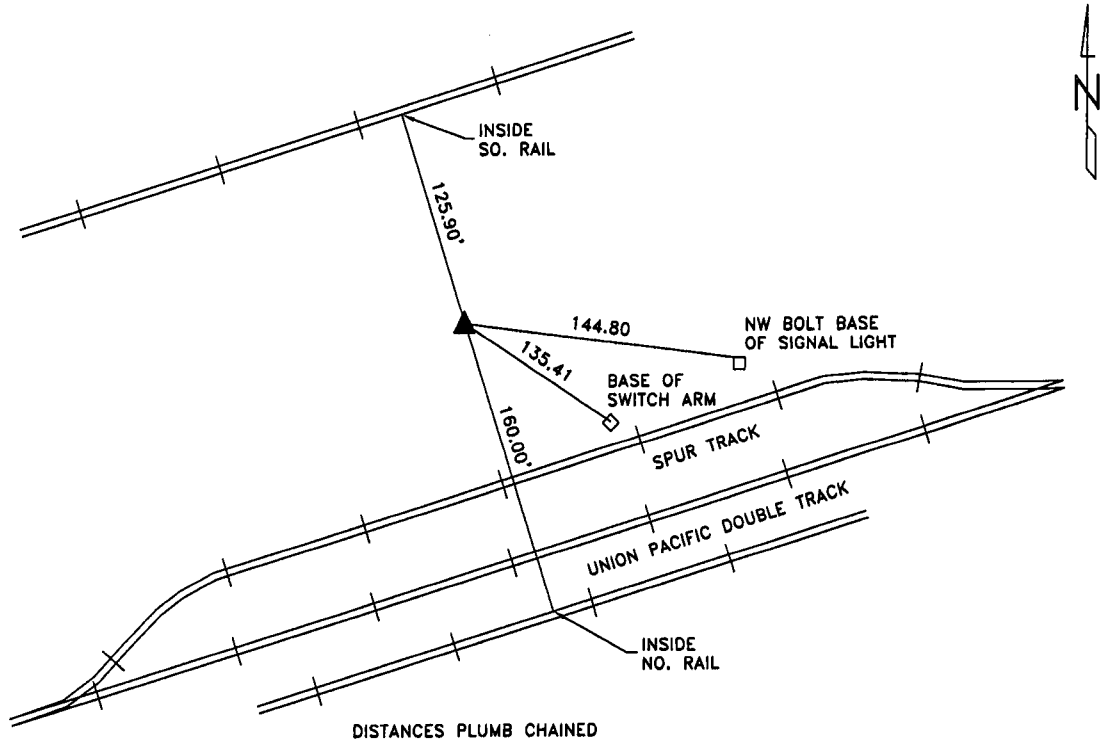

NE CORNER SECTION 2-82-40

I HEREBY CERTIFY THAT THIS LAND SURVEYING DOCUMENT WAS PREPARED
AND THE RELATED SURVEY WORK WAS PERFORMED BY ME OR UNDER MY
DIRECT PERSONAL SUPERVISION AND THAT I AM A DULY LICENSED LAND
SURVEYOR UNDER THE LAWS OF THE STATE OF IOWA.

Terence E. Crawford
TERENCE E. CRAWFORD
IA LICENSE NO. 8893

DATE
APR 11 2006
EXP. DATE DECEMBER 31, 2007

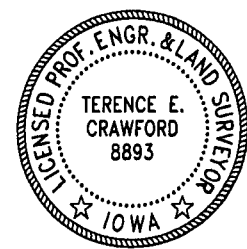

SE PROJECT NO. 21306
DRAWN BY: LLL