

3-2 Using Ch. Bk # 9 PP 65 as reference
 retraced Fischer's work, found
 Painted limestone $9\frac{1}{2}$ " \times steel
 bar 15" long at a depth of 15"
 and 26'5" South of NE Cor of
 3-82-40. Low creel evidence \times set
 C.M. 12" below ground.
 ties from x-spts
 976.0 South of E. of M.L. RR.
 140.2 SW of x on N headwall of Cement Culic
 131.8 SW " " " S " " " "
 1108.7 NW of signal tower
 138.7 SE of car post

34 Mt location indicated by random chain evidence.
 3 found old car post a 1/2" year
 Stake 22" long about 23 yards
 of present car post. Lowland
 evidence \times set C.M. 12" below ground

Ties from x-spts.

1970 WNW of 30" elier
 309.4 SSE of 18" walnut
 23 NW of car post

30-55-5
 Found a Set 4-21-42
 Stammer Lowland Limb
 Chief Chapman

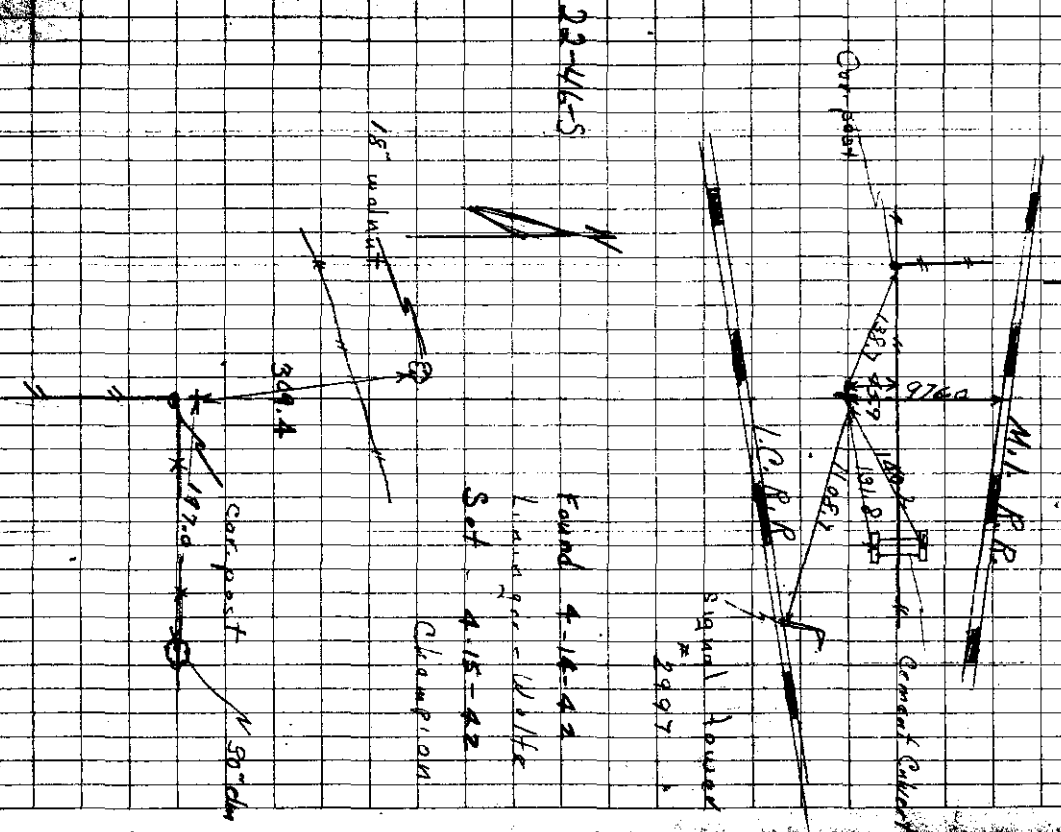

22-46-5

Found 4-18-42
 Lowland - 14 1/2 ft

Set 4-15-42
 Champion

309.4

Car post
 150" dia

1970