

SCANNED

Crawford County Recorder
Denise Reeves
Fee Book 2012-0636
03/20/2012 03:39PM
PLC: PLAT CORNER CER
Book: Page: # Pages: 1
Total Fees: \$7.00

PREPARED BY - TERENCE E. CRAWFORD - SUNDQUIST ENGINEERING - 120 S. MAIN, DENISON, IOWA 51442 - PHONE (712) 263-0118

UNITED STATES PUBLIC LAND SURVEY CORNER CERTIFICATE OF

LAND SURVEY MONUMENT SITUATED IN SECTION 8, T 82 N, R 40 W OF
THE 5TH P.M., CRAWFORD COUNTY, IOWA.
PREVIOUSLY RECORDED IN BOOK _____, PAGE _____, OTHER _____

MONUMENT DESCRIPTION AND REMARKS

NW CORNER
SE1/4 SW1/4 - FOUND IRON PIN W/ORANGE CAP #5798 0.3' DEEP.
NE CORNER
SE1/4 SW1/4 - FOUND IRON PIN W/ORANGE CAP #5798 1.5' DEEP.

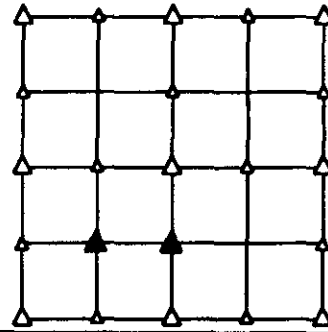

PLAN VIEW SHOWING RELATIVE LOCATION OF MONUMENT AND REFERENCE POINTS.

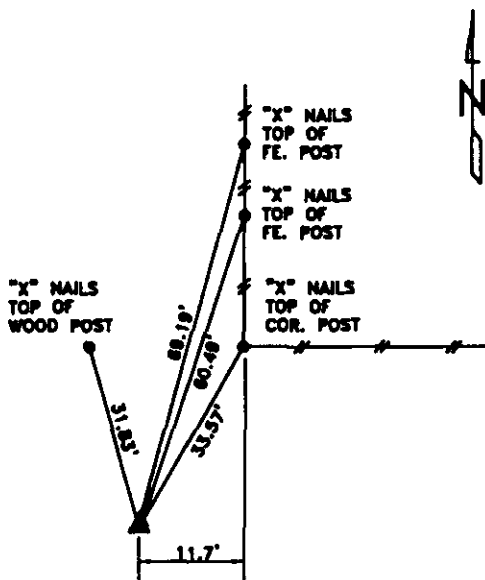

DISTANCES PLUMB CHAINED
NW CORNER SE1/4 SW1/4
SECTION 8-82-40

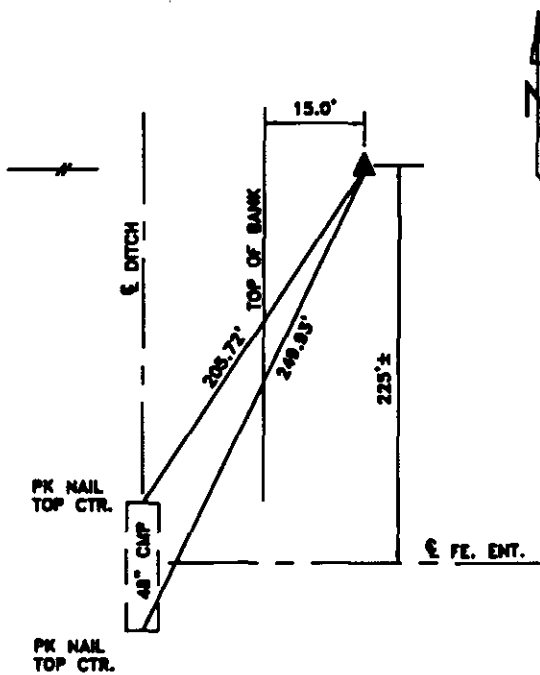

DISTANCES PLUMB CHAINED
NE CORNER SE1/4 SW1/4
SECTION 8-82-40

I HEREBY CERTIFY THAT THIS LAND SURVEYING DOCUMENT WAS PREPARED AND THE RELATED SURVEY WORK WAS PERFORMED BY ME OR UNDER MY DIRECT PERSONAL SUPERVISION AND THAT I AM A DULY LICENSED LAND SURVEYOR UNDER THE LAWS OF THE STATE OF IOWA.

Terence E. Crawford 2-24-12
TERENCE E. CRAWFORD DATE

IA LICENSE NO. 8893

EXP. DATE DECEMBER 31, 2013

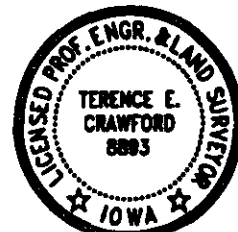

SE PROJECT NO. 20512
DRAWN BY: LLL