

Sara Meseck, RECORDER
 Crawford County, Iowa
 Instr. Number: 2026-0751
 Recorded: 4/16/2026 at 12:00:41.0 PM
 Pages 1
 County Recording Fee: \$7.00
 Iowa E-Filing Fee: \$3.13
 Combined Fee: \$10.13
 Revenue Tax:

PREPARED BY AND RETURN TO: MIKE SCHULTE, SCHULTE SURVEYING, INC., 2003 390TH STREET, WESTSIDE, IA 51467 (712) 790-3489

UNITED STATES PUBLIC LAND SURVEY CORNER CERTIFICATE OF
 LAND SURVEY MONUMENTS SITUATED IN SECTION 36, TOWNSHIP 82 NORTH, RANGE 39 WEST, OF THE FIFTH
 PRINCIPAL MERIDIAN, CRAWFORD COUNTY, IOWA. PREVIOUSLY RECORDED IN SEE BELOW IN COUNTY
(book, page instrument number)
 RECORDER'S OFFICE.

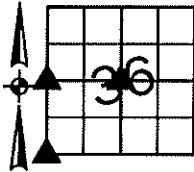

SW CORNER
 FND CONCRETE MONUMENT WITH 3/8" REBAR 10" DEEP
 N=7188360.21 E=16605989.62 Z=1395.34
 USED CERTIFICATE RECORDED IN INSTRUMENT #90-2106 AND A
 METAL LOCATOR TO FIND A CONCRETE MONUMENT WITH A 3/8"
 REBAR 10" DEEP, 20.16' WEST OF ROAD CENTERLINE. VERIFIED
 WITH 1 REMAINING TIE.
 THIS CERTIFICATE IS BEING FILED TO UPDATE THE REFERENCE TIES.

W1/4 CORNER
 FND 5/8" REBAR 6" DEEP
 N=7190992.33 E=16605979.95 Z=1404.11
 USED CERTIFICATE RECORDED IN INSTRUMENT #90-2106 AND A
 METAL LOCATOR TO FIND A 5/8" REBAR 6" DEEP, +/- 20.5' WEST OF
 ROAD CENTERLINE. VERIFIED WITH 2 REMAINING TIES.
 THIS CERTIFICATE IS BEING FILED TO UPDATE THE REFERENCE TIES.

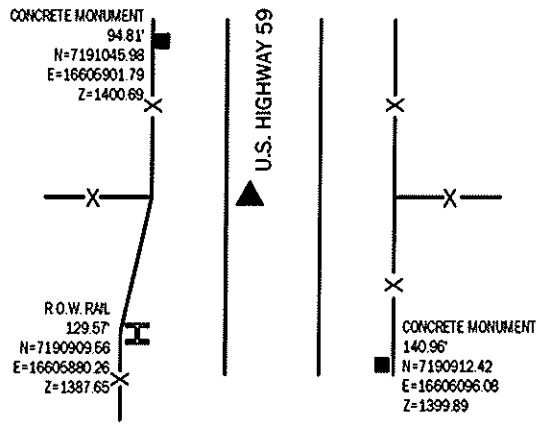

*X NAILS IN POWER POLE
 98.72'
 N=7188294.89
 E=16605915.61
 Z=1394.90

5/8" REBAR
 199.08'
 N=7188479.31
 E=16606149.15
 Z=1414.22

5/8" REBAR
 156.15'
 N=7188283.59
 E=16606125.68
 Z=1409.45

CENTER
 SET 5/8" REBAR YPC #17979
 N=7191029.38 E=16608615.96 Z=1384.76
 NO RECORD OF CORNER FOUND. LANDOWNER SAID A STONE WAS
 FOUND WHEN SETTING NEW POST. VERIFIED POSITION OF POST
 AND SET A 5/8" REBAR YPC #17979 AT SE CORNER. VERIFIED WITH
 SURROUNDING FIELD EVIDENCE.
 THIS CERTIFICATE IS BEING FILED DUE TO NONE OF RECORD.

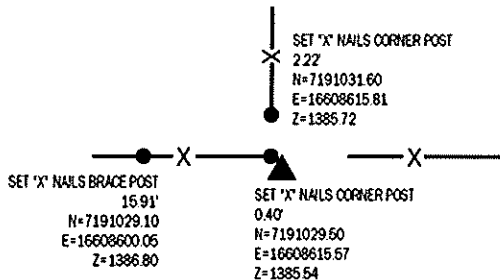

*All distances are measured horizontally unless noted.

I HEREBY CERTIFY THAT THIS LAND SURVEYING DOCUMENT WAS
 PREPARED BY ME OR UNDER MY DIRECT PERSONAL SUPERVISION AND
 THAT I AM A DULY LICENSED PROFESSIONAL LAND SURVEYOR UNDER
 THE LAWS OF THE STATE OF IOWA.

Mike Schulte
 MIKE SCHULTE
 LICENSE NUMBER 17979
 LICENSE RENEWAL DATE IS DECEMBER 31, 2027
 PAGES COVERED BY THIS SEAL: 1 OF 1

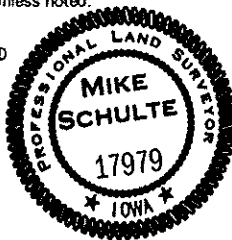

LIST CORNERS TO BE INDEXED

CORNER	SECTION	TWP	RANGE
CENTER	36	82	39
W1/4 CORNER	36	82	39
E1/4 CORNER	35	82	39
SW CORNER	36	82	39
SE CORNER	35	82	39

BASIS OF BEARING

IA RCS ZONE 6 - US SURVEY FEET
 (EARTH DERIVED - NAD83(2011)(EPOCH 2010.00))

SCHULTE SURVEYING, INC.

DRAWN BY: SLG
 PROJ NUMBER: 25-079