

Sara Meseck, RECORDER
 Crawford County, Iowa
 Instr. Number: 2023-2283
 Recorded: 12/27/2023 at 4:09:24.0 PM
 Pages 1
 County Recording Fee: \$7.00
 Iowa E-Filing Fee: \$3.13
 Combined Fee: \$10.13
 Revenue Tax:

PREPARED BY AND RETURN TO: MIKE SCHULTE, SCHULTE SURVEYING, INC., 2003 390TH STREET, WESTSIDE, IA 51467 (712) 790-3489

UNITED STATES PUBLIC LAND SURVEY CORNER CERTIFICATE OF
 LAND SURVEY MONUMENTS SITUATED IN SECTION 01, TOWNSHIP 84 NORTH, RANGE 37 WEST, OF THE FIFTH
 PRINCIPAL MERIDIAN, CRAWFORD COUNTY, IOWA. PREVIOUSLY RECORDED IN SEE BELOW IN COUNTY
(book, page instrument number)
 RECORDER'S OFFICE.

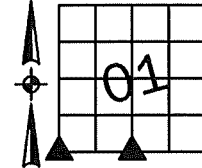

SW CORNER
 FND 80D SPIKE 5" DEEP
 N=7277649.17 E=16668926.98

USED CERTIFICATE RECORDED IN INSTRUMENT #99-1755 AND A METAL LOCATOR TO FIND A 80D SPIKE 5" DEEP AS DESCRIBED ON CERTIFICATE. VERIFIED WITH 2 REMAINING TIES. THIS CERTIFICATE IS BEING FILED TO UPDATE THE REFERENCE TIES.

S1/4 CORNER
 FND 5/8" REBAR YPC #8893
 N=7277681.51 E=16671556.72

USED CERTIFICATE RECORDED IN INSTRUMENT #2003-4512 AND A METAL LOCATOR TO FIND A 5/8" REBAR YPC #8893. VERIFIED WITH SURROUND FIELD EVIDENCE. THIS CERTIFICATE IS BEING FILED TO UPDATE THE REFERENCE TIES.

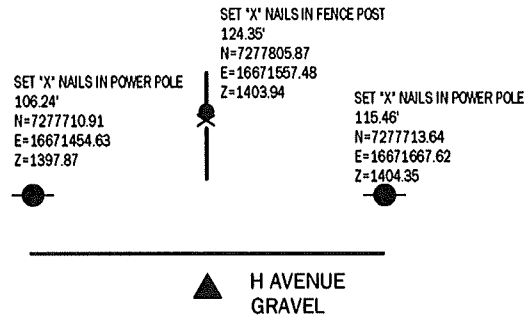
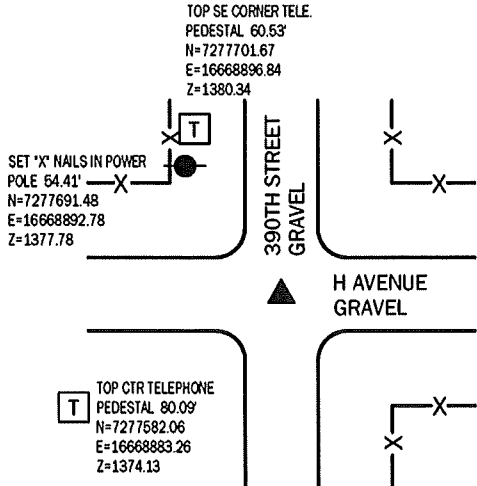

*All distances are measured horizontally unless noted.

I HEREBY CERTIFY THAT THIS LAND SURVEYING DOCUMENT WAS PREPARED BY ME OR UNDER MY DIRECT PERSONAL SUPERVISION AND THAT I AM A DULY LICENSED PROFESSIONAL LAND SURVEYOR UNDER THE LAWS OF THE STATE OF IOWA.

Mike Schulte
 MIKE SCHULTE
 LICENSE NUMBER 17979
 LICENSE RENEWAL DATE IS DECEMBER 31, 2023
 PAGES COVERED BY THIS SEAL: 1 OF 1
 DATE 2023/12/20



LIST CORNERS TO BE INDEXED

CORNER	SECTION	TWP	RANGE
SW CORNER	1	84	37
SE CORNER	2	84	37
NE CORNER	11	84	37
NW CORNER	12	84	37
S1/4 CORNER	1	84	37
N1/4 CORNER	12	84	37

BASIS OF BEARING

laRCS ZONE 6 - US SURVEY FEET
 laRTN DERIVED - NAD83(2011)(EPOCH 2010.00)