

28 27

33 34

Found Brick Bat at a depth
 of 2'. Stove door broken in small pieces
 at a depth of 2 1/2' Brick bat around
 stove door. Lime stand 3' x 8' x 10' at a
 depth of 3' Set C.M.

Ties from x-spks

49.4 SW from Cor Post

~~45.3~~

SE

near edge 7" Cor post

50.4 NW

N N

N N

N N

N N

70.1 N.W.W

N N

N N

N N

N N

N N

N N

N N

N N

N N

N N

50.3 SW near

edge

Tele Pole

16-41-F

Found 9-2-29-39

4-112-49

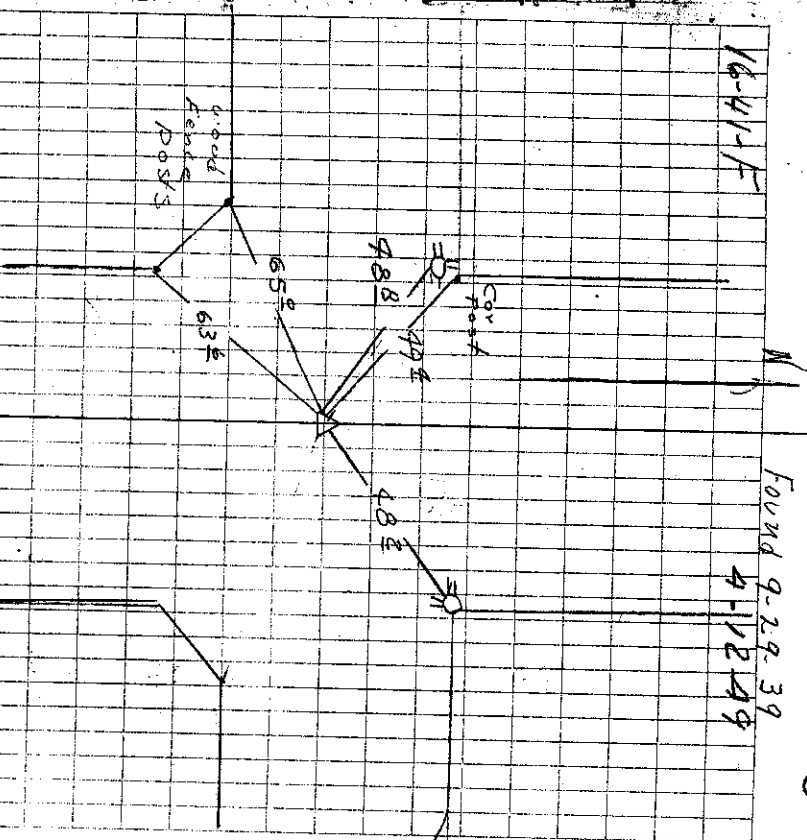

9-P-83 Used Co. Traxcard to find broken C.M.S.D.
 deep. Set 1 1/4" iron pin 18" deep. New Ties.
 Found for Co. Cused grading job 2 miles East
 Ellenton, Bernhardt, Kearnes