

2000 AP 27 AM 11:18

INST. NO. 2000-1073

DENISE MEEVES, RECORDER

Denise Meeves

FEE \$6.00

Mary Luten, Deputy

George A. Parris, PE, LS, JEO Consulting Group, Inc. 628 N. Main Suite 101, Carroll, Iowa 51401, 712-792-9711

UNITED STATES PUBLIC LAND SURVEY
CORNER CERTIFICATE

Land Survey Monument Situated in Section 8
Township 84 North Range 37 West, of the 5th P.M.
Crawford County, Iowa.

Monument Description and Remarks:

Found Lead Plug in Concrete Pavement 2.15 feet west of centerline joint.

PLAN - VIEW
West Quarter Corner
SECTION 8 - T84N-R37W

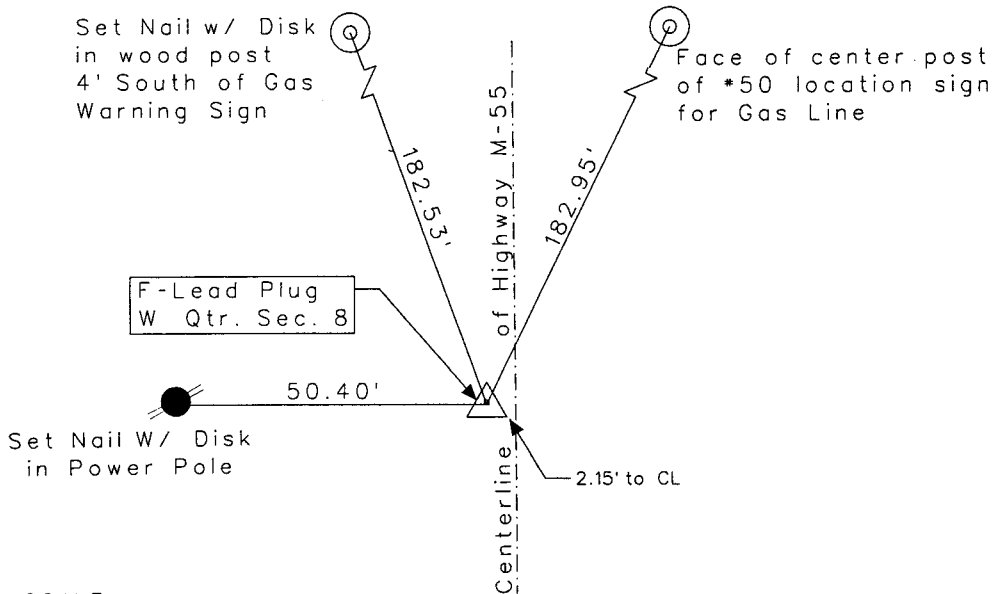

NO SCALE

4/00

All ties are " X " nails unless noted otherwise

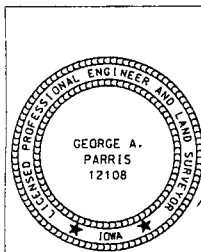

I hereby certify that this land surveying document was prepared and the related survey work was performed by me or under my direct personal supervision and that I am a duly licensed Land Surveyor under the laws of the State of Iowa.

George A. Parris 4/26/00
George A. Parris Date
My license renewal date is December 31, 2000

Sheets covered by this seal:

ALL

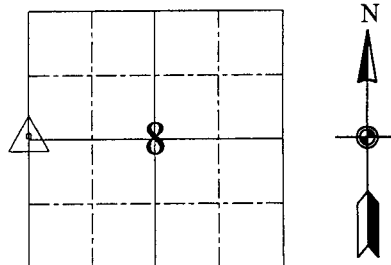

List Corner to be Indexed

Corner	Section	Twp	Range
W 1/4	8	84	37