

INDEXED
 FOLLOW UP
 PROOFED
 SCHEDULED



Crawford County Recorder Denise Meeves
 Fee Book 2007-0169 REC013194
 01/17/2007 8:11:36AM # Pages 1
 PLC PLAT CORNER CER
 Total Fees: \$0.00

PREPARED BY: MICKAEL BERNDT
 CRAWFORD COUNTY ENGINEERS OFFICE - COURTHOUSE - DENISON, IA. - 712-263-2449

**UNITED STATES PUBLIC LAND SURVEY CORNER CERTIFICATE
 OF**

LAND SURVEY MONUMENT SITUATED IN WILLOW TOWNSHIP, THE NORTHWEST
 CORNER OF SECTION 12, T-83N, R-41W OF THE 5TH P.M. CRAWFORD COUNTY, IOWA.

PREVIOUSLY RECORDED AS NO.

MONUMENT DESCRIPTION AND REMARKS

NORTHWEST CORNER SEC. 12-83-41

11-01-06
 FOUND CM 2' DEEP. TIED OFF CORNER AND COUNTY BEGAN GRADING ROAD.

11-27-06
 THE CM WAS DESTROYED WHEN THE COUNTY GRADED THE ROAD. A 5/8" X 14" REBAR WITH
 YELLOW CAP #14808 WAS SET BACK AT A DEPTH OF 6".



NORTHWEST CORNER SEC. 12-83-41

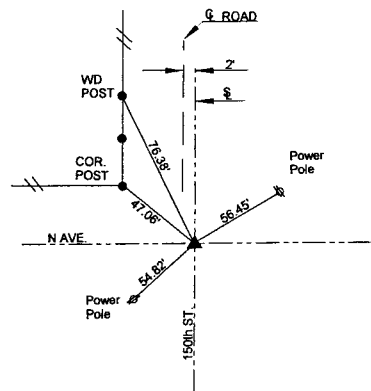

ALL DISTANCES ARE SLOPED CHAINED

All ties are "X" nails unless otherwise noted.

CORNER: NORTHWEST
 SECTION: 12
 TOWNSHIP: 83N
 RANGE: 41W

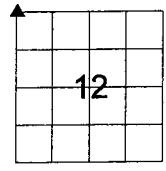

CERTIFICATION: I HEREBY CERTIFY THAT THIS LAND SURVEYING DOCUMENT WAS PREPARED AND THE RELATED SURVEY WORK WAS PERFORMED BY ME OR UNDER MY DIRECT PERSONAL SUPERVISION AND THAT I AM A DULY LICENSED LAND SURVEYOR UNDER THE LAWS OF THE STATE OF IOWA.			
<i>Michael F. Berndt</i> Signature	1-17-07 Date of Survey		
Mickael F. Berndt Typed Name	14808 L.S. No.	Dec. 31, 2008 License Renewal Date	
Pages covered by this seal <u>1</u>			