

INDEXED DM
 FOLLOW UP g
 PROOFED JB
 SCANNED g

PREPARED BY: PAUL ASSMAN-CRAWFORD COUNTY ENGINEER'S OFFICE-COURTHOUSE-DENISON, IA.-712-263-2449

**UNITED STATES PUBLIC LAND SURVEY CORNER CERTIFICATE
 OF**

LAND SURVEY MONUMENT SITUATED IN WILLOW TOWNSHIP, THE NORTHEAST CORNER OF SECTION 13, T-83N,
 R-41W OF THE FIFTH P.M. CRAWFORD COUNTY, IOWA.

PREVIOUSLY RECORDED AS NO. 2006-3104

MONUMENT DESCRIPTION AND REMARKS

NORTHEAST CORNER SEC. 13-83-41

FOUND 5/8" REBAR 1.0' DEEP
 RETIED CORNER.

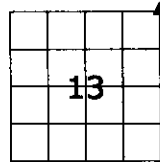

NORTHEAST CORNER SEC. 13-83-41

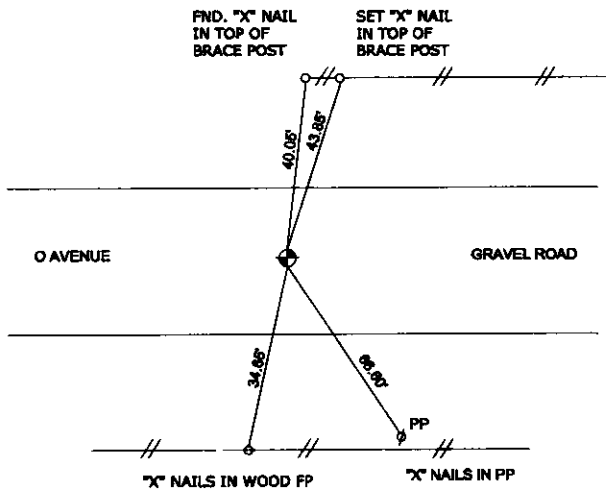

ALL DISTANCES ARE SLOPE CHAINED

CERTIFICATION:

I HEREBY CERTIFY THAT THIS LAND SURVEYING DOCUMENT WAS PREPARED AND THE RELATED SURVEY WORK WAS PERFORMED BY ME OR UNDER MY DIRECT PERSONAL SUPERVISION AND THAT I AM A DULY LICENSED LAND SURVEYOR UNDER THE LAWS OF THE STATE OF IOWA.

Signature Paul J. Assman Date of Survey 7/17/13

PAUL J. ASSMAN 11982 12-31-14
 Typed Name L.S. No. License Renewal Date

Pages covered by this seal 1

