

INDEXED WCE
 FOLLOW UP _____
 PROC: ED _____

STATE OF IOWA
 CRAWFORD COUNTY

96 APR -3 AM 9:46

INST. NO. 96-1047
 DENISE MEEVES, RECORDER
Denise Meeves
 FEE: 6.00

This document prepared by: Semke & Associates - 712-792-2276
 Micheal G. Semke, L.S. #10318 - 608 N. Court St., Carroll, Iowa

UNITED STATES PUBLIC LAND SURVEY CORNER CERTIFICATE
 OF

Land Survey Monuments situated in Section 21, Township 83, Range 41, of the Fifth Principal Meridian, Crawford County, Iowa. Previously recorded in _____ in County Recorder's Office.
(book, page, document number, etc.)

(Show reason for preparing this certificate, the evidence and detailed procedures used in establishing the corner positions and monumentation found or placed.)

PLAN - VIEW

(Show a minimum of three reference ties to durable physical objects, relevant monuments and physical conditions that will enable recovery of the corner.)

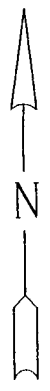
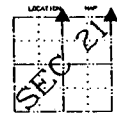
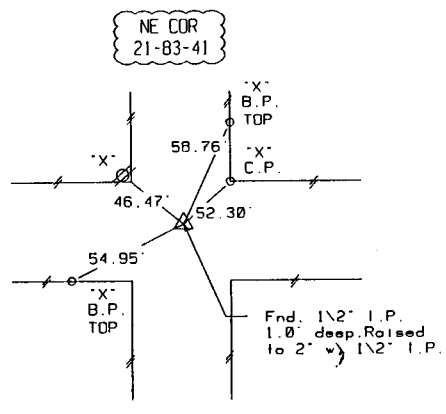

N 1/4 COR 21-83-41

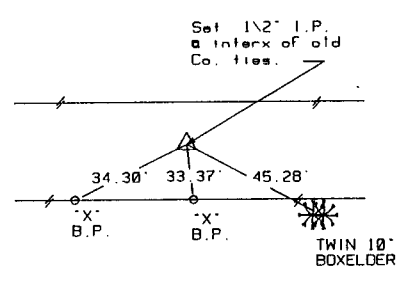

ALL TIES SLOPE CHAINED UNLESS OTHERWISE NOTED.

I HEREBY CERTIFY THAT THIS CORNER CERTIFICATE WAS PREPARED BY ME OR UNDER MY DIRECT PERSONAL SUPERVISION AND THAT I AM A DULY REGISTERED LAND SURVEYOR UNDER THE LAWS OF THE STATE OF IOWA. MY REGISTRATION EXPIRES 12-31-97.
 4-1-96
 DATE

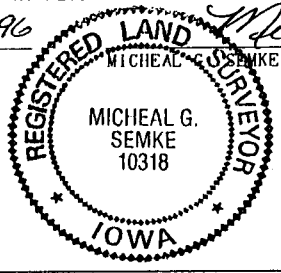

List Corners to be Indexed			
Corners	Section	Twp	Range
NE COR	21	83	41
SE COR	16	83	41
SW COR	15	83	41
NW COR	22	83	41
N 1/4	21	83	41
S 1/4	16	83	41