

**UNITED STATES PUBLIC LAND SURVEY CORNER CERTIFICATE  
OF**

LAND SURVEY MONUMENT SITUATED IN SECTION 24, T 83 N, R 41 W OF  
THE 5TH P.M., CRAWFORD COUNTY, IOWA.  
PREVIOUSLY RECORDED IN BOOK \_\_\_\_\_, PAGE \_\_\_\_\_, OTHER \_\_\_\_\_

**MONUMENT DESCRIPTION AND REMARKS**

W1/4 CORNER - SET 5/8" IRON PIN W/CAP #8893 0.6' DEEP, AT  
SPLIT & ON LINE BETWEEN NW & SW COR. OF SEC.  
SW CORNER - SET 5/8" IRON PIN W/CAP #8893 FLUSH ON LINE  
WITH FENCE LINE SOUTH & IN E-W FENCE

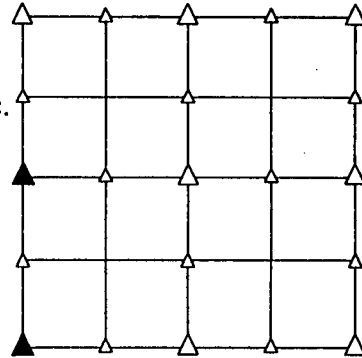

**PLAN VIEW SHOWING RELATIVE LOCATION OF MONUMENT AND REFERENCE POINTS.**

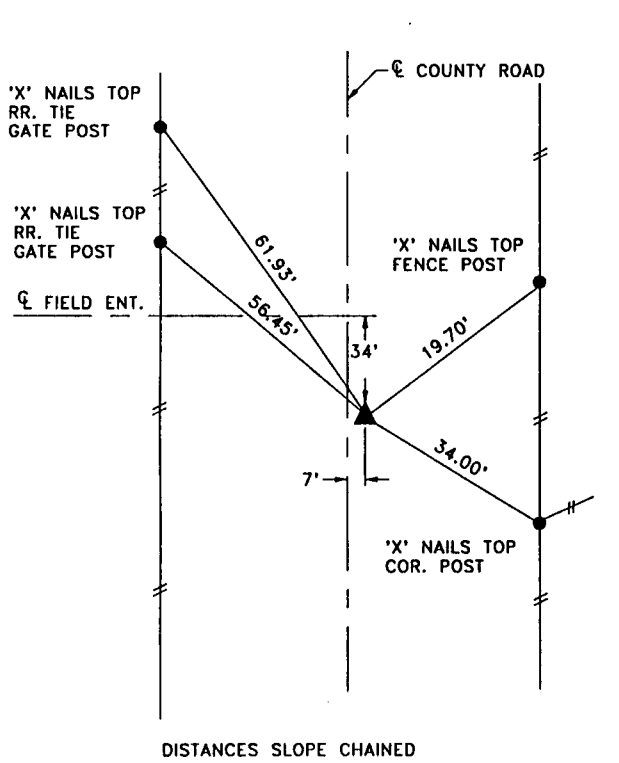

W1/4 CORNER SEC. 24-83-41

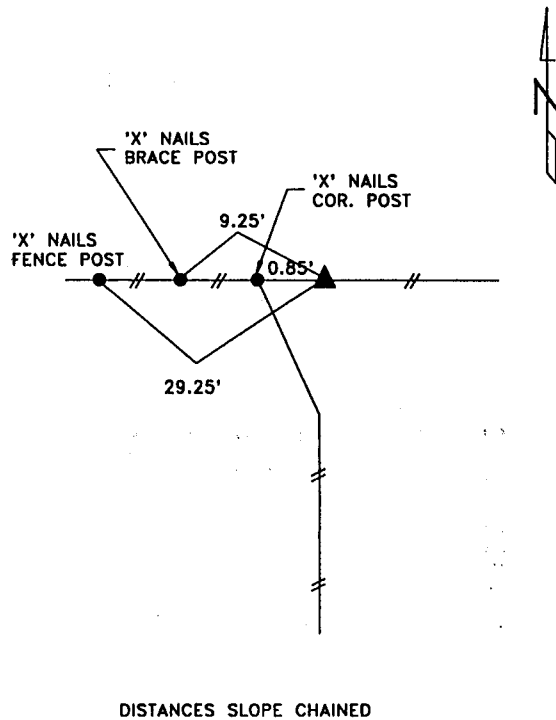

SW CORNER SEC. 24-83-41

I HEREBY CERTIFY THAT THE SURVEY WORK WAS COMPLETED AND THIS LAND SURVEYING DOCUMENT WAS PREPARED BY ME OR UNDER MY DIRECT PERSONAL SUPERVISION AND THAT I AM A DULY LICENSED LAND SURVEYOR UNDER THE LAWS OF THE STATE OF IOWA.

Terence E. Crawford 1-8-97  
TERENCE E. CRAWFORD DATE

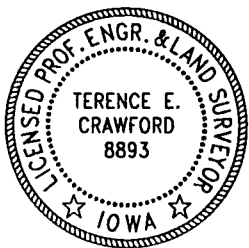

IA LICENSE NO. 8893  
EXP. DATE DECEMBER 31, 1997  
SE PROJECT NO. 2616

SUNDQUIST ENGINEERING, P.C.  
120 SOUTH MAIN, P.O. BOX 220  
DENISON, IOWA 51442 PH. (712)263-8118

RECORDING OFFICER  
FILED DENISON, IOWA  
CRAWFORD COUNTY  
97 JAN -8 PH 1:01  
INST. NO. 97-0074  
DENISE NEEVES, RECORDER  
Denise Neeves  
FEE: 6.00

INDEXED         
FOLLOW UP         
PROOFED