

54

Dug 1 1/2 x 1 1/2 x 15' hole in
of E Fence did not find anything

32
0

Found brick bats 16" deep
1/2" iron rod 36" long at a
depth of 16" lowered set C.M.

Ties from X" nails
27.1 S.W. from Wood Post
36.5 S.W. from Wood Post
50.9 N.E. from Wood Post
42.2 N.E. from Brace Post
40.9 N. from Corner Post

27-25-5

500845 5-13-40 11

FOUNDED 9-25-39

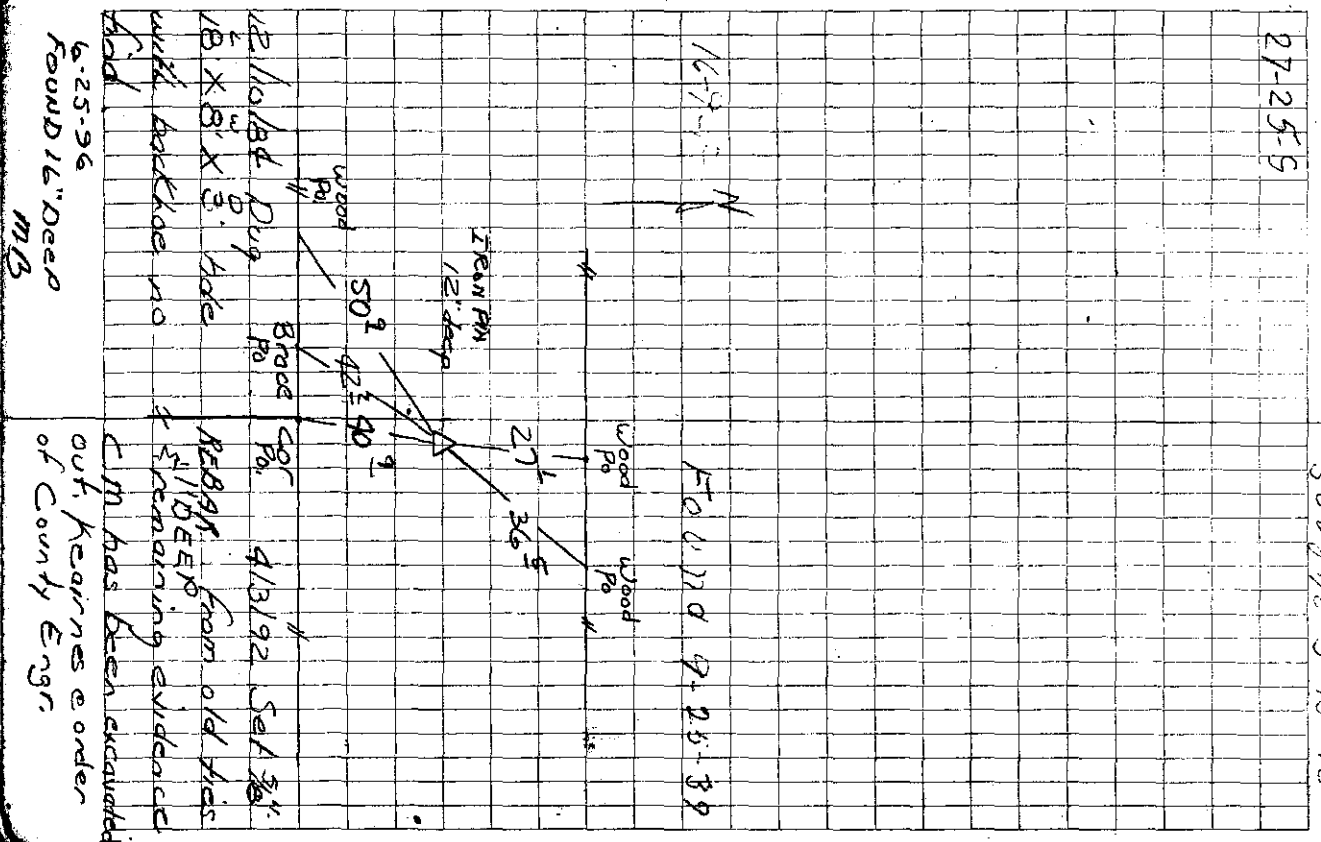

6-25-96
FOUND 16" Deep
MB

C.M. has been excavated
out. Kearnes & order
of County Engr.